

HR TYPE HOSE REEL

(Standard)

- **Maximum Working pressure** less than 1.5MPa{15kgf/cm²}
- **Fluid** ... Air, nitrogen, argon, carbon dioxide, general hydraulic oil, grease, industrial water

※Please contact us if the hose reel has different application from above fluids.

●HR-2205~3A516W

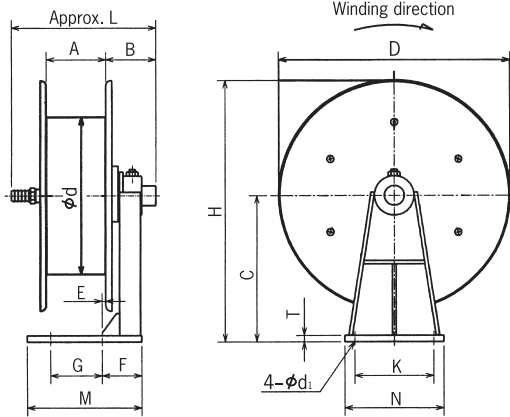

●HR-4524~6975T

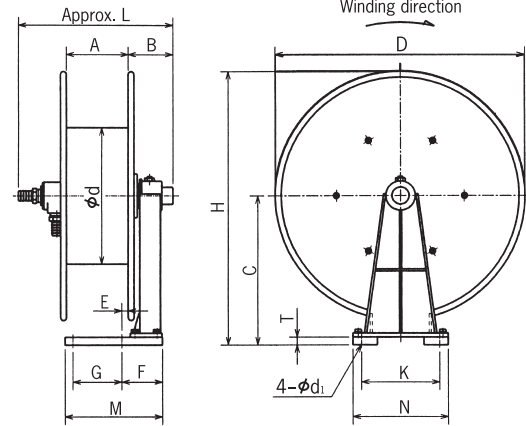

Specifications and Dimensions

Model	Max Torque N·m(kgf·m)	Max spring tension N(kgf)	Max spring turns n	Connection size Rc	Dimensions (mm)															Mass (kg)
					D	d	A	B	C	H	L	E	G±1	K±1	M	N	F	T	d ₁	
HR-2205	4.9 {0.5}	49{5.0}	20	3/8	292	200	75	64	185	331	185	5.0	65	100	145	125	50.5	8	9	8
HR-2305	4.9 {0.5}	49{ 5.0}	20	3/8	350	200	75	64	215	390	185	5.0	65	100	145	125	50.5	8	9	9
HR-2A305W	4.9 {0.5}	49{ 5.0}	39	3/8	350	200	110	64	215	390	220	22.5	65	100	145	125	68.0	8	9	11
HR-3416	15.6{1.6}	132{13.5}	13	1/2	440	230	75	65	260	480	195	4.0	65	100	145	125	50.5	8	9	12
HR-3A409W	8.8 {0.9}	73{ 7.5}	38	1/2	440	230	110	65	260	480	230	22.5	65	100	145	125	68.0	8	9	16
HR-3A416W	15.6{1.6}	132{13.5}	26	1/2	440	230	110	65	260	480	230	21.5	65	100	145	125	68.0	8	9	16
HR-3A516W	15.6{1.6}	132{13.5}	26	1/2	510	230	110	65	300	555	230	21.5	65	100	160	150	73.5	8	9	20
HR-4524	23.5{2.4}	166{17.0}	13	3/4	510	280	127	90	305	560	320	13.5	100	160	200	195	83.5	16	13	27
HR-4524W	23.5{2.4}	166{17.0}	26	3/4	510	280	127	90	305	560	320	13.5	100	160	200	195	83.5	16	13	32
HR-4524T	23.5{2.4}	166{17.0}	39	3/4	510	280	127	90	305	560	320	13.5	100	160	200	195	83.5	16	13	38
HR-4624W	23.5{2.4}	166{17.0}	26	3/4	630	280	127	90	370	685	320	13.5	100	160	228	200	83.5	16	13	36
HR-4624T	23.5{2.4}	166{17.0}	39	3/4	630	280	127	90	370	685	320	13.5	100	160	228	200	83.5	16	13	41
HR-5736	35.3{3.6}	196{20.0}	13	1	750	360	127	82	435	810	330	13.5	100	160	245	245	94.5	19	13	46
HR-5736W	35.3{3.6}	196{20.0}	26	1	750	360	127	82	435	810	330	13.5	100	160	245	245	94.5	19	13	53
HR-5736T	35.3{3.6}	196{20.0}	39	1	750	360	127	82	435	810	330	13.5	100	160	245	245	94.5	19	13	60
HR-6855	53.9{5.5}	245{25.0}	12	1 1/4	870	440	166	82	500	935	390	23.0	120	200	286	295	104.0	22	13	66
HR-6855W	53.9{5.5}	245{25.0}	24	1 1/4	870	440	166	82	500	935	390	23.0	120	200	286	295	104.0	22	13	77
HR-6855T	53.9{5.5}	245{25.0}	36	1 1/4	870	440	166	82	500	935	390	23.0	120	200	286	295	104.0	22	13	88
HR-6975W	73.5{7.5}	333{34.0}	24	1 1/4	1000	440	166	97	565	1065	390	23.0	120	200	301	335	119.0	22	13	102
HR-6975T	73.5{7.5}	333{34.0}	36	1 1/4	1000	440	166	97	565	1065	390	23.0	120	200	301	335	119.0	22	13	117

NOTE: 1. Suffix -R on all model names identifies reverse winding.

2. Installation plate (base plate) for HR-2205~3A516W is welded. If you prefer to set it reverse, please notify us in advance. Suffix -1 on model name identifies reverse setting.

3. For HR-4524~6975T, setting the installation plate (base plate) reverse is available by yourself, unless the base plate is not welded (special spec.). However, in case of reinforced bracket type (special spec.), the reverse setting is not applied.

4. For any special fluids, please contact us.

5. For any special requirements, please contact us.

Model description

HR-4524W

Number of springs
(No mark=1, W=2, T=3)

Spring type

Drum cover dia.

Drum width (A-wide)

Hose reel

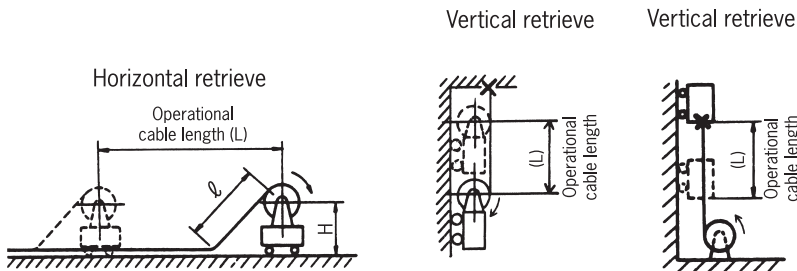
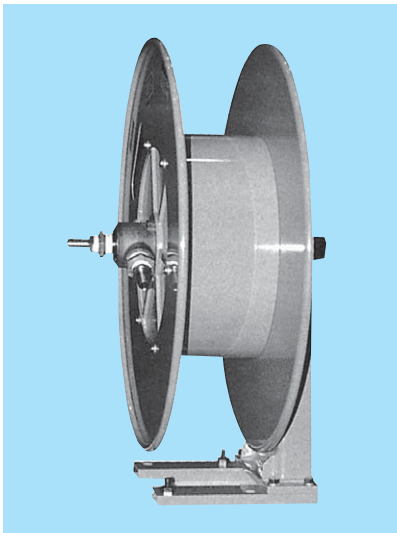

<div> <div>Operational cable length (L)</div> <div>Hose size</div> </div>	HR Type	Mobile application/Horizontal & vertical retrieve, Stationary application/Vertical retrieve					
	5m	10m	15m	20m	25m	30m	35m
$\phi 6.3 \times \phi 13.8$	2205	2305	2A305W	2A305W	3A409W		
$\phi 6.3 \times \phi 14.5$	2205	2305	2A305W	2A305W	3A409W		
$\phi 9.5 \times \phi 17$	2305	2A305W	3A409W	3A409W	4524T	4624T	
$\phi 9.5 \times \phi 18$	2305	2A305W	3A409W	3A409W	4524T	4624T	
$\phi 12.7 \times \phi 20.5$	3416	3A416W	3A516W	4524W	4624T	4624T	5736T
$\phi 12.7 \times \phi 22.5$	3416	3A416W	3A516W	4524W	4624T	4624T	5736T
$\phi 15.9 \times \phi 25$	4524	4524W	4624W	4624W	5736W	5736T	6855T
$\phi 15.9 \times \phi 26$	4524	4524W	4624W	4624W	5736W	5736T	6855T
$\phi 19 \times \phi 27.5$	4524	4624W	4624W	5736W	5736T	5736T	6855T
$\phi 19 \times \phi 30$	5736	5736	5736W	5736W	5736T	6855W	6855T
$\phi 25.4 \times \phi 34$	5736	5736	5736W	6855W	6855W	6855T	6975T
$\phi 25.4 \times \phi 37.5$	6855	6855	6855W	6855W	6855T	6975W	6975T
$\phi 31.8 \times \phi 44$	6855	6855	6855W	6975W	6975W		
$\phi 31.8 \times \phi 47$	6855	6855	6855W	6975W			

NOTE: 1.Calculated at following conditions:

①Fluid·········· Air

②Working pressure···· 1.0MPa {10kgf/cm²}

③Application········ Mobile application/Horizontal & vertical retrieve, Stationary application/Vertical retrieve

④Maximum travel/lift·· less than 30mm/min

⑤Installation height ···

HR-2205~3A516W···less than 0.5m

HR-4524~6975T····less than 1.0m

2. Deviations due to roller guides, non-straight cable payout, low ambient temperature, etc. are not calculated. When selecting a model, please take into consideration of high mechanical stress and harsh environment conditions.